

Instruction Manual CM 01U Amp Modulator

Multistandard High-quality
DSB modulators w. build in amplifier
Multistandard Høj kvalitets DSB modulator
med indbygget forstærker

CM 01 UHF+AMP 300116

Simply more
- more simply



Specification

Specifications

CM 01 TV Modulator / Modulateur MA	Specifications
Output Frequency / Fréquences de sortie / Ausgangs-frequenz / Canali di uscita / Frecuencia de Salida	UHF 470-862
Max. Input level / Max. Niveau entrée / Max. Eingangspegel / Max. Livello di ingresso / Max. Nivel de Entrada/Max. Indgangs niveau	77 dBµV
Gain from RF in to RF Out 1 Out 2 (47-862MHz)	Out 1 +2 dB Out 2 +10 dB
Output level from modulator / Niveau sortie modulateur/ Ausgangspegel modulator Livello di uscita RF modulatore/ Nivel de Salida modulador	Out 1 72 dBµV Out 2 82 dBµV
AV Input level / AV Niveau entrée / AV Eingangspegel / AV Livello di ingresso / AV Nivel de Entrada	Audio 0,5 - 1,0 Vrms Video 0,8..1,0 Vpp

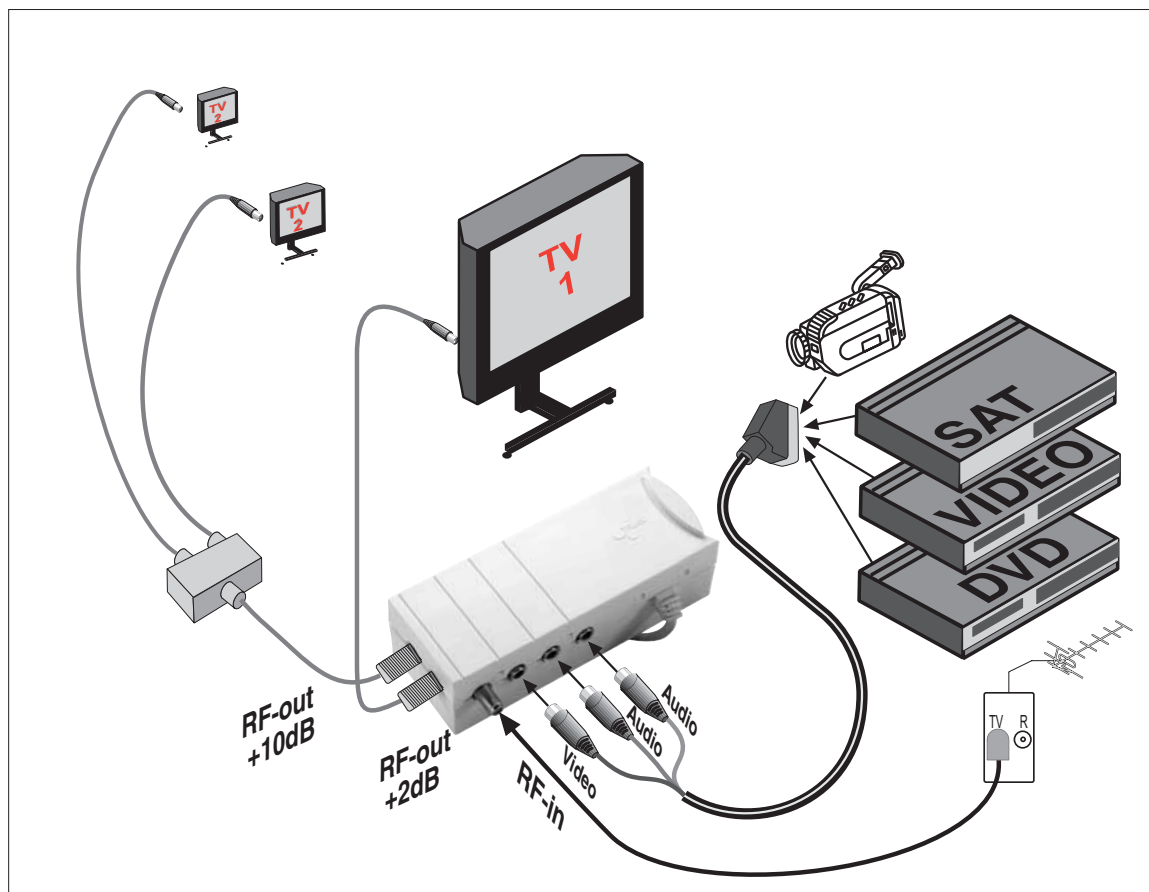

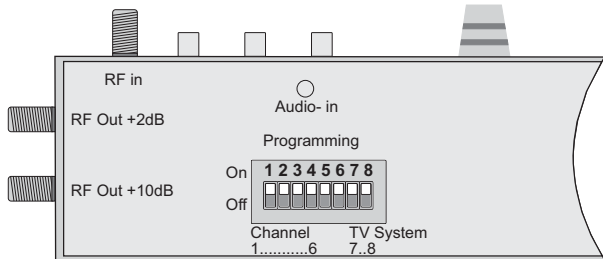

B/G
(VHF)/(UHF)

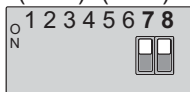

(EU + Australia)

I

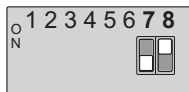

(UK + New Zealand)

D/K
(VHF)/(UHF)

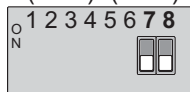

(Eastern part of EU)

L

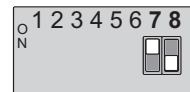

(France)

Output Channel selection
Selección de Sistema TV

CM01 VHF

CM01 UHF

System/Sistema	System/Sistema
B E05 L L05 I I04 D R06	S19 S22 S21 S21
E06 L06 I 05 R07	S20 S23 S22 S22
E07 L07 I 06 R08	S21 S24 S23 S23
E08 L08 I 07 R09	S23 S25 S25
E09 L09 I 08 R10	S23 S25 S25
E10 L10 I 09 R11	S24 S24
E11 L11 I 10 R12	S25 S25
E12 L12 I 11 R13	
S11 L13 I 12 R14	
S12 L14 I 13 R15	
S13 L15 I 14 R16	
S14 L16 I 15 R17	
S15 L17 I 16 R18	
S16 L18 I 17 R19	
S17 L19 I 18 R20	
S18 S21 I 19 R21	

System/Sistema	Channel No. Canales
B E 05... E12, S11...S25 L L 05... L19, S21...S25 I I 04... I 19, S21...S25 D R06... R 21, S21...S25	
ITALY B III	
CH D	
CH E	
CH F	
CH G	
CH H	
CH H1	
CH H2	

21	37	53
22	38	54
23	39	55
24	40	56
25	41	57
26	42	58
27	43	59
28	44	60
29	45	61
30	46	62
31	47	63
32	48	64
33	49	65
34	50	66
35	51	67
36	52	68
		69

System/Sistema	Channel No./Canales
G	CH 21...CH69
L	CH 21...CH69
I	CH 21...CH69
K	CH 21...CH69